

# Three-Position Original Line Cylinders

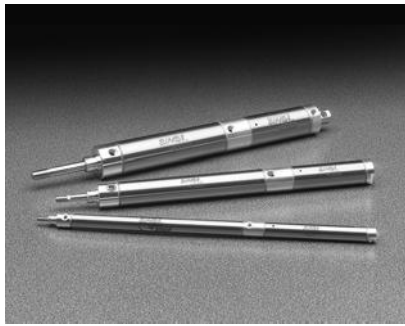

*Bimba's Three-Position Original Line stainless steel body cylinder provides three positions with a single cylinder. Bimba offers the performance and quality of the unitized Original Line cylinder design along with its product breadth now in three positive stroke positions.*

## How to Order

The model number for all Three-Position Original Line cylinders consists of three alphanumeric clusters. These designate product type, bore size and stroke length, and options. Please refer to the charts below for an example of model number

M-043/4.5-DW. This is a 3/4" bore, with a 3" stroke for position A, plus an additional 4-1/2" stroke for position B, double acting cylinder with a rod wiper.

Product Type	Bore Sizes	Stroke A	Stroke B	Standard Stroke Lengths and Stroke Maximums
Blank – Three-position Original Line M – Magnet option for cylinders* NR – Non-rotating rod option	02 – 9/16" 04 – 3/4" 09 – 1-1/16" 17 – 1-1/2" 31 – 2"	0.5 = 1/2" 1 = 1" 1.5 = 2-1/2" 3.75 = 3-3/4" etc.	0.5 = 1/2" 1" = 1" 2.5 = 2-1/2" 3.75 = 3-3/4" etc.	Nose Mount 1" increments to 12" 2 x Stroke A + Stroke B Maximum = 12" Universal Mount 1" increments to 24" 2 x Stroke A + Stroke B Maximum = 32"

\*Magnet located on stroke B piston only.

**M - 043 / 4.5 - D W**

Mounting Options	Options
D – Double acting, nose mount DXP – Double acting, universal mount	(Enter in alphabetical order, except EE which is last) B – Bumpers E – Non-lube seals and lubrication F – Molycoated body G – Magnalube® G K – Ports rotated 90 degrees N – Low temperature seals & lubrication NT – Non-threaded rod Q – Side ported rear head (see standard Original Line information for applicable length adders by bore size) T – Switch Track (T2, T3 or T4), see Related Products, page 8.12 V – High temperature seals & lubrication W – Rod wiper EEX.XX – Extra rod extension

Note: Consult page 1.4 for option combination compatibility.

## Specifications

Expected life:	1400 miles when lubricated
Total stroke tolerance:	
9/16" – 1-1/2"	+.075/- .040
2":	+.095/- .060
Operating Medium:	Air only
Maximum Operating Pressure:	250 psi
Temperature Range:	-20°F to 200°F
Standard Lubrication:	HT-99
Endcaps, center section, and piston material:	Aluminum
Cylinder body:	304 stainless steel
Piston and rod seals:	Buna N "U" cups
Rod and pivot bushings:	Sintered bronze
Piston rod:	303 stainless steel

# Three-Position Original Line Cylinders

## List Prices

Bore	Mounting		Total
	Mounting-D List Price	-DXP List Price	combined stroke adder, per inch**
02 - 9/16"	\$31.45	\$34.80	\$1.50
04 - 3/4"	34.30	39.40	1.50
09 - 1-1/16"	39.60	45.05	1.50
17 - 1-1/2"	53.70	60.10	2.35
31 - 2"	74.35	83.75	2.65

\*\*Total combined stroke = (2 X stroke A) + Stroke B

Bore	Options								
	M (Prefix) Magnetic Position Sensing	B Bumpers	E Non-lube Seals and Lubrication	F Molycoated Body per inch	N Low Temperature Seals	V High Temperature Seals and Lubrication	W Rod Wiper	EE Extra Rod Extension per inch	NR Prefix Non-rotating rod
9/16" (02)	\$9.15	\$7.95	\$16.00	\$2.55	\$2.35	\$20.65	\$2.75	\$0.80	\$16.35
3/4" (04)	9.15	7.95	16.60	2.55	2.35	20.65	2.75	0.80	16.35
1-1/16" (09)	11.40	7.95	18.30	2.55	3.45	24.85	2.75	0.80	21.80
1-1/2" (17)	13.75	9.65	19.45	2.55	4.60	27.40	2.75	1.20	21.80
2" (31)	16.00	12.35	28.75	2.55	5.75	35.10	5.50	1.30	26.25

No Charge Options: G, K, NT

## Dimensions

D Mounting Style (in.)

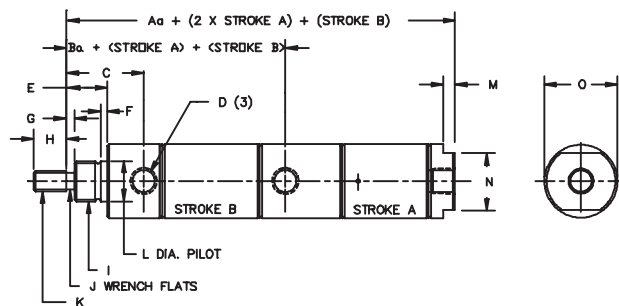

DXP Mounting Style (in.)

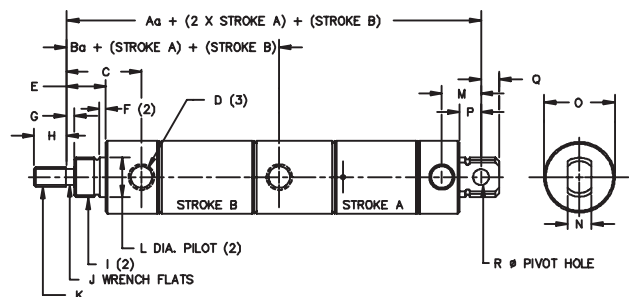

D Model																Bumper Option	
Bore	Aa	Ba	C	D	E	F	G	H	I	J	K	L	M	N	O	Aa	Ba
9/16" (02)	4.12	2.25	0.75	#10-32	0.38	0.06	N/A	0.50	7/16-20	N/A	#10-32	.434/.437	0.19	0.50	0.62	4.31	2.31
3/4" (04)	5.47	3.12	0.97	1/8 NPT	0.50	0.09	N/A	0.50	5/8-18	N/A	1/4-28	.621/.624	0.19	0.62	0.81	5.47	3.12
1-1/16" (09)	5.97	3.25	1.19	1/8 NPT	0.62	0.09	0.12	0.50	5/8-18	0.25	5/16-24	.621/.624	0.49	0.88	1.12	6.09	3.25
1-1/2" (17)	6.5	3.69	1.50	1/8 NPT	0.88	0.09	0.25	0.75	3/4-16	0.38	7/16-20	.746/.749	0.25	0.88	1.56	6.62	3.69
2" (31)	8.25	4.78	1.92	1/4 NPT	1.19	0.12	0.38	0.88	1-1/4-12	0.50	1/2-20	1.375/1.372	0.31	1.25	2.09	8.62	4.91

DXP Model																			Bumper Option	
Bore	Aa	Ba	C	D	E	F	G	H	I	J	K	L	M	N	O	P	Q	R	Aa	Ba
9/16" (02)	4.41	2.25	0.75	#10-32	0.38	0.06	N/A	0.50	7/16-20	N/A	#10-32	.434/.437	0.38	0.31	0.62	0.25	0.19	0.157	4.66	2.31
3/4" (04)	6.25	3.12	0.97	1/8 NPT	0.50	0.09	N/A	0.50	5/8-18	N/A	1/4-28	.621/.624	0.62	0.38	0.86	0.34	0.28	0.250	6.25	3.12
1-1/16" (09)	6.56	3.25	1.19	1/8 NPT	0.62	0.09	0.12	0.50	5/8-18	0.25	5/16-24	.621/.624	0.62	0.38	1.12	0.34	0.28	0.250	6.68	3.25
1-1/2" (17)	7.18	3.69	1.50	1/8 NPT	0.63	0.09	0.25	0.75	3/4-16	0.38	7/16-20	.746/.749	0.81	0.62	1.56	0.50	0.38	0.375	7.31	3.69
2" (31)	9.19	4.78	1.92	1/4 NPT	1.19	0.12	0.38	0.88	1-1/4-12	0.50	1/2-20	1.375/1.372	1.03	0.75	2.08	0.56	0.44	0.375	9.56	4.91